

CFI-1100 series

| Issued | Checked | Approved |
|--|---------|--|
| <div>SIE CS '21.08.31 Miyawaki</div> | | <div>SIE CS '21.08.31 Monden</div> |

SM-PS5-0033E-04

PlayStation®5

ASSY SERVICE MANUAL 4th edition
for EDM-020 BOARD

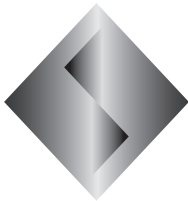

Sony
Interactive
Entertainment

Sony Interactive Entertainment
CS Department
Published in Japan ©2021.08

SAFETY CHECK-OUT

After correcting the original service problem, perform the following safety checks before releasing the set to the customer:

1. Check the area of your repair for unsoldered or poorly soldered connections. Check the entire board surface for solder splashes and bridges.
2. Check the interboard wiring to ensure that no wires are “pinched” or contact high-wattage resistors.
3. Look for unauthorized replacement parts, particularly transistors, that were installed during a previous repair. Point them out to the customer and recommend their replacement.
4. Look for parts which, though functioning, show obvious signs of deterioration. Point them out to the customer and recommend their replacement.
5. Check the power cable for cracks and abrasion. Recommend the replacement of any such power cable to the customer.
6. Check the B+ voltage to see it is at the values specified.
7. Check the metal trim, “metallized” knobs, screws, and all other exposed metal parts for AC leakage. Check leakage as described below.

SAFETY-RELATED COMPONENT WARNING!!

COMPONENTS IDENTIFIED BY MARK \triangle OR DOTTED LINE WITH MARK \triangle ON THE SCHEMATIC DIAGRAMS AND IN THE PARTS LIST ARE CRITICAL TO SAFE OPERATION. REPLACE THESE COMPONENTS WITH SONY PARTS WHOSE PART NUMBERS APPEAR AS SHOWN IN THIS MANUAL OR IN SUPPLEMENTS PUBLISHED BY SONY.

ATTENTION AU COMPOSANT AYANT RAPPORT À LA SÉCURITÉ!!

LES COMPOSANTS IDENTIFIÉS PAR UNE MARQUE \triangle SUR LES DIAGRAMMES SCHÉMATIQUES ET LA LISTE DES PIÈCES SONT CRITIQUES POUR LA SÉCURITÉ DE FONCTIONNEMENT. NE REMPLACER CES COMPOSANTS QUE PAR DES PIÈCES SONY DONT LES NUMÉROS SONT DONNÉS DANS CE MANUEL OU DANS LES SUPPLÉMENTS PUBLIÉS PAR SONY.

SPECIAL COMPONENT NOTICE

The components identified by mark \triangle contain confidential information.
Strictly follow the instructions whenever the components are repaired and/or replaced.

LEAKAGE TEST

The AC leakage from any exposed metal part to earth ground and from all exposed metal parts to any exposed metal part having a return to chassis, must not exceed 0.5 mA (500 microampers.). Leakage current can be measured by any one of three methods.

1. A commercial leakage tester, such as the Simpson 229 or RCA WT-540A. Follow the manufacturers’ instructions to use these instruments.
2. A battery-operated AC milliammeter. The Data Precision 245 digital multimeter is suitable for this job.
3. Measuring the voltage drop across a resistor by means of a VOM or battery-operated AC voltmeter. The “limit” indication is 0.75 V, so analog meters must have an accurate low-voltage scale. The Simpson 250 and Sanwa SH-63Trd are examples of a passive VOM that is suitable. Nearly all battery operated digital multimeters that have a 2 V AC range are suitable. (See Fig. A)

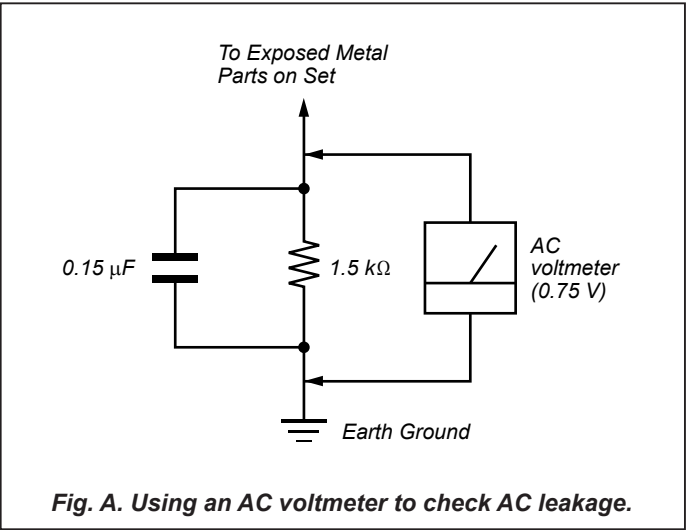

CAUTION:

The use of optical instruments with this product will increase eye hazard.

CAUTION

Use of controls or adjustments or performance of procedures other than those specified herein may result in hazardous radiation exposure.

WARNING!!

WHEN SERVICING, DO NOT APPROACH THE LASER EXIT WITH THE EYE TOO CLOSELY. IN CASE IT IS NECESSARY TO CONFIRM LASER BEAM EMISSION, BE SURE TO OBSERVE FROM A DISTANCE OF MORE THAN 25 cm FROM THE SURFACE OF THE OBJECTIVE LENS ON THE OPTICAL PICK-UP BLOCK.

CAUTION

The use of optical instruments with this product will increase eye hazard. As the laser beam used in this CD/DVD ROM Drive is harmful to eyes, do not attempt disassemble the cabinet. Refer servicing to qualified personnel only.

CAUTION

Ensure that this product is disconnected from the power plug before the laser protective housing is removed.

CAUTION

CLASS 2 LASER RADIATION INSIDE THE EQUIPMENT. DO NOT CONNECT TO AC MAINS WHEN IT IS DISASSEMBLED.

CAUTION

Ensure that this product is disconnected from the power plug before the laser protective housing is removed.

CAUTION

Risk of explosion if battery is replaced by an incorrect type. Dispose of used batteries according to the instructions.

Lithium Batteries

If an equipment is provided with a replaceable lithium battery, the following applies:

- if the battery is placed in an OPERATOR ACCESS AREA, there shall be a warning close to the battery or in both the operating and the service instructions:
- if the battery is placed elsewhere in the equipment, there shall be a warning close to the battery or in the service instructions.

CHANGE NOTE

| Edition | Date | Description |
|---------|------------|---|
| 1st | | |
| 2nd | 2021/06/30 | Add AU3 , BR2 With DRIVE (FOX) and Change Red characters. |
| 3rd | 2021/07/21 | Add J1(SKZ) , RU3 , BR2(FOX) and Change Red characters. |
| 4th | 2021/08/31 | Add UCS , E32 , EU8 With DRIVE and RU3 , UCS , E32 and Change Red characters. |
| | | |
| | | |
| | | |
| | | |
| | | |
| | | |



TABLE OF CONTENTS

- 1-1. OVERALL SECTION
- 1-2. UPPER SIDE SECTION
- 1-3. LOWER SIDE SECTION
- 1-4. MCB BLOCK SECTION
- 1-5. BD BLOCK SECTION
- 1-6. ACCESSORIES & PACKING MATERIALS

SECTION 1
EXPLODED VIEWS

NOTE:

- The mechanical parts with no reference number in the exploded views are not supplied.
- Accessories are given in the last of this parts list.

The components identified by mark  or dotted line with mark  are critical for safety. Replace only with part number specified.

Les composants identifiés par une marque  sont critiques pour la sécurité. Ne les remplacer que par une pièce portant le numéro spécifié.

NOTE:

- SC Classification:
S : Supplied parts U : Unsupplied parts

CAUTION
Use of controls or adjustments or performance of procedures other than those specified herein may result in hazardous radiation exposure.

SPECIAL COMPONENT NOTICE

The components identified by mark  contain confidential information. Strictly follow the instructions whenever the components are repaired and/or replaced.

Addreviated name for Color Variation:
Color : Original

UPPER SIDE VIEW

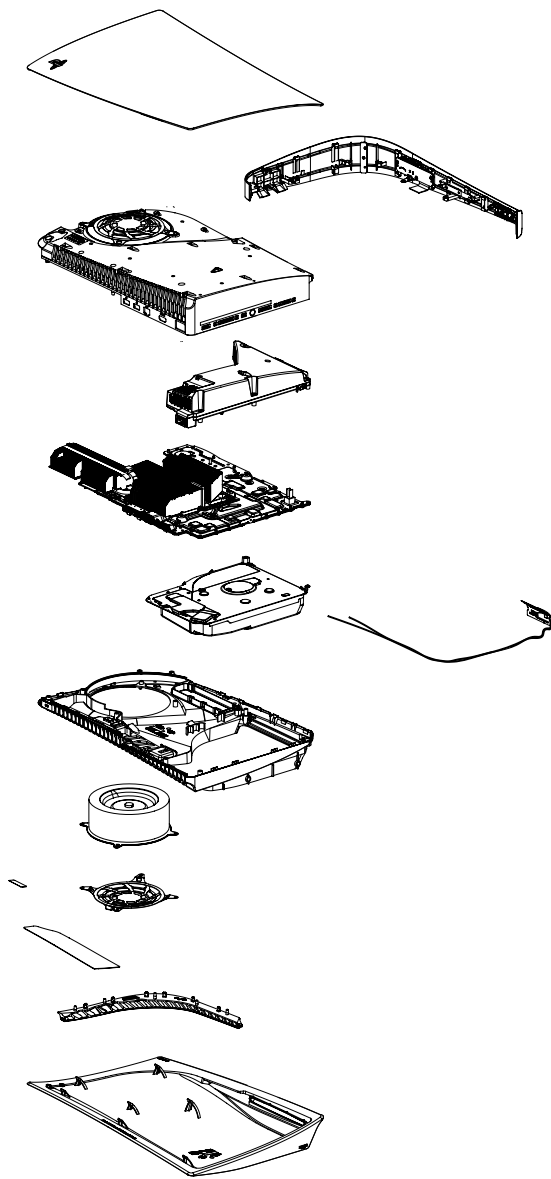

LOWER SIDE VIEW

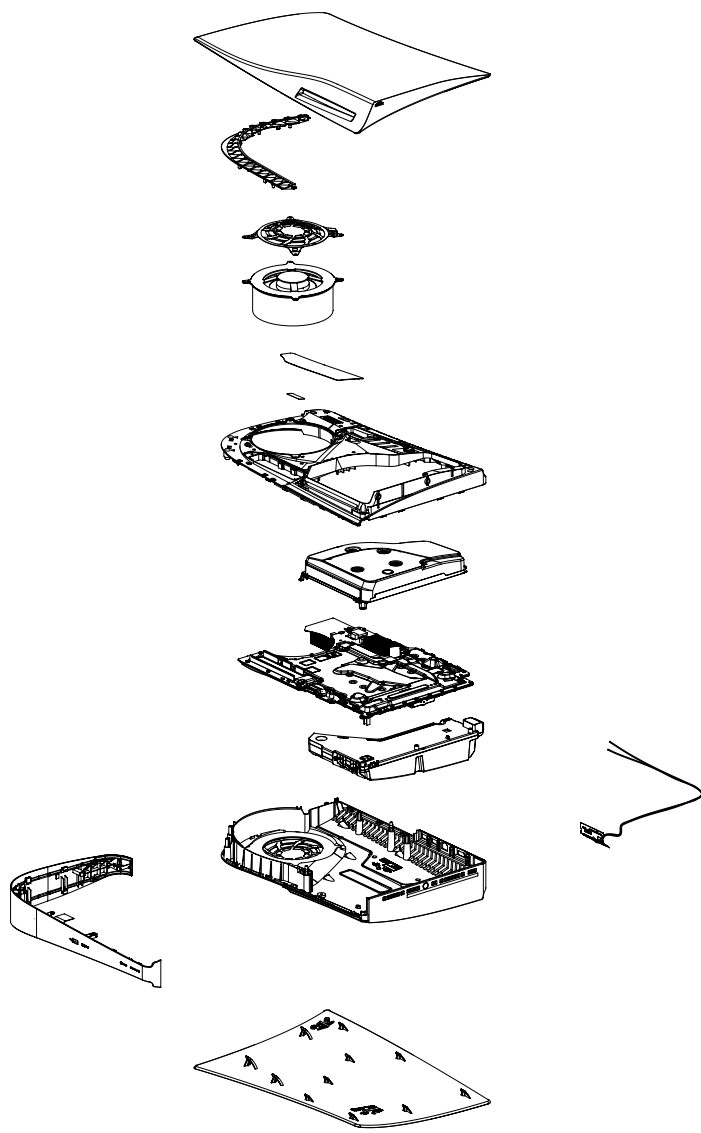

1-1. OVERALL SECTION

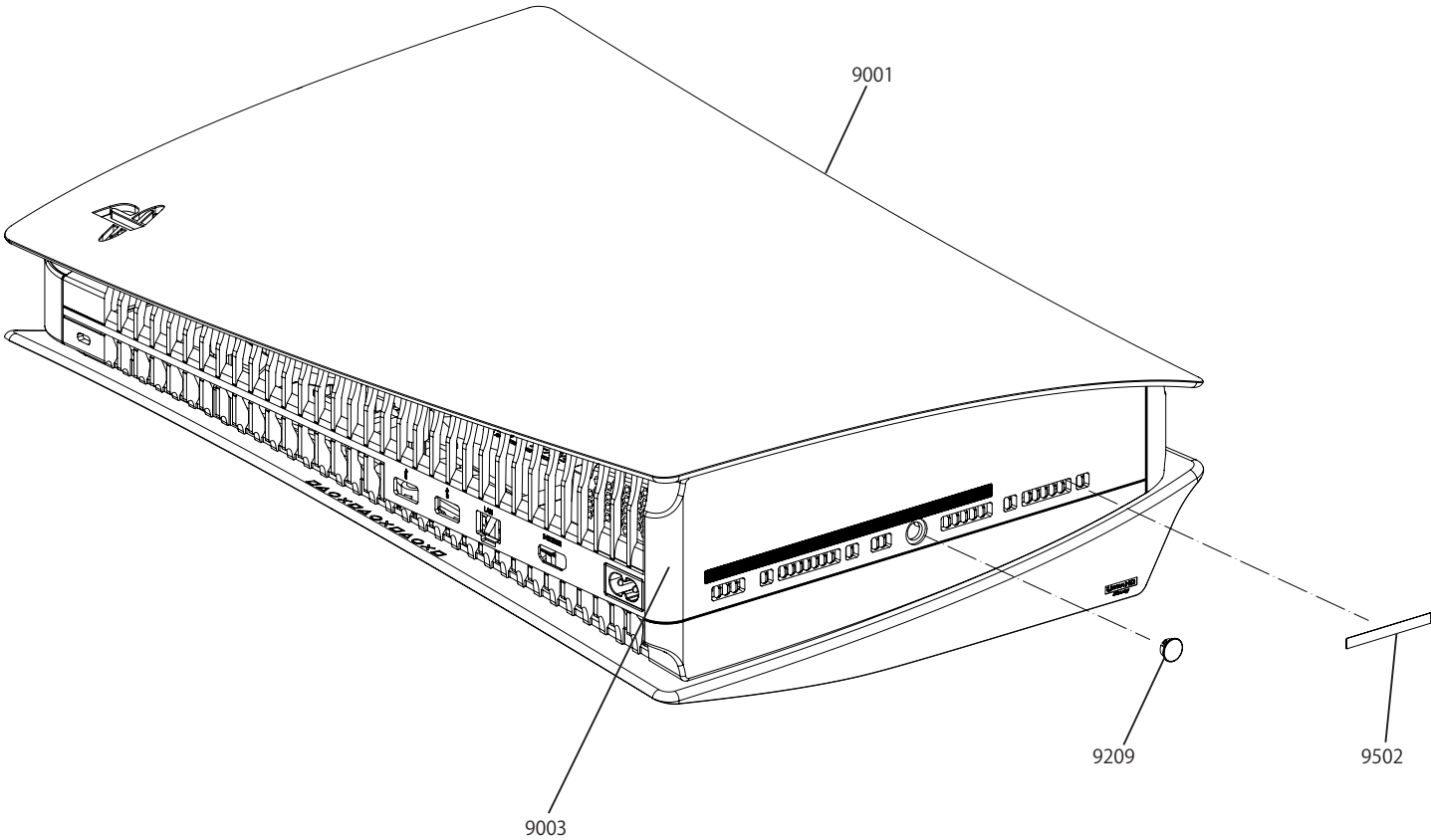

| SC | Ref. No | Part No. | Description | Remarks |
|----|---------|--------------|-------------|---------|
| S | 9209 | 5-019-677-01 | BASE CAP | |
| S | 9001 | 5-016-786-02 | PANEL UPPER | |

| SC | Ref. No. | Description | Specification | Part No. | | | | | | | | |
|----|----------|-------------------------|---------------------------------------|--------------|--------------|--------------|-------------------------------------|--------------|--------------|--|--|--|
| S△ | 9003 | CABINET ASSY, UPPER (S) | with BD-Drive | EBF/J1/J | EBF/J1/C | EBF/J1/C2 | EB/AU3/C | EB/RU3/C | EB/CN9/C | | | |
| | | | | A-5037-802-A | A-5037-803-A | | A-5037-807-A | A-5037-813-A | - | | | |
| | | | | EB/BR2/C | EBF/UCS/J | EBF/UCS/C | EBF/UCS/C2 | EB/EU8/C | EB/E32/C | | | |
| | | | | A-5037-809-A | A-5037-796-A | A-5037-799-A | A-5037-814-A | A-5037-798-A | A-5040-683-A | | | |
| | | | | EBA/J1/J | EBA/J1/C | EBA/J1/C2 | EBA/UCS/J | EBA/UCS/C | EBA/UCS/C2 | | | |
| | | | | A-5038-208-A | A-5038-209-A | | A-5037-797-A | A-5037-800-A | A-5037-815-A | | | |
| | | | without BD-Drive <Digital Edition> | | DBF/J1/C | DBF/J1/C2 | DB/AU3/C | DB/RU3/C | DB/CN9/C | | | |
| | | | | - | A-5037-804-A | | A-5037-808-A | A-5039-261-A | - | | | |
| | | | | DB/BR2/C | | DBF/UCS/C | DBF/UCS/C2 | DB/EU8/C | DB/E32/C | | | |
| | | | | A-5037-810-A | - | A-5037-805-A | A-5037-775-A | A-5037-801-A | A-5040-684-A | | | |
| | | | | | DBA/J1/C | DBA/J1/C2 | | DBA/UCS/C | DBA/UCS/C2 | | | |
| | | | | - | A-5038-210-A | | - | A-5037-806-A | A-5037-776-A | | | |
| | | | Remarks | | | | ***/**/J : Manufactured by SKZ | | | | | |
| | | | | | | | ***/**/C : Manufactured by FOXCONN | | | | | |
| | | | | | | | ***/**/C2 : Manufactured by Goertek | | | | | |
| | | | | | | | EBF , DBF : Wlan Module (Freeza) | | | | | |
| | | | | | | | EBA , DBA : Wlan Module (Almeida) | | | | | |

| | | | | | | | | |
|---|------|---------------|---------------------------------------|--------------|--------------|--------------|-----|--------------|
| S | 9502 | LABEL, SERIAL | with BD-Drive | J | AU3 | RU3 | CN9 | BR2 |
| | | | | 9-886-040-34 | 9-886-040-36 | 9-886-040-40 | - | 9-886-040-38 |
| | | | | UCS | EU8 | E32 | | |
| | | | | 9-886-040-30 | 9-886-040-31 | 9-886-040-42 | | |
| | | | without BD-Drive <Digital Edition> | J | AU3 | RU3 | CN9 | BR2 |
| | | | | 9-886-040-35 | 9-886-040-37 | 9-886-040-41 | - | 9-886-040-39 |
| | | | | UCS | EU8 | E32 | | |
| | | | | 9-886-040-32 | 9-886-040-33 | 9-886-040-43 | | |

| | |
|--|--|
| The components identified by mark △ or dotted line with mark △ are critical for safety. Replace only with part number specified. | Les composants identifiés par une marque △ sont critiques pour la sécurité. Ne les remplacer que par une pièce portant le numéro spécifié. |
|--|--|

1-2. UPPER SIDE SECTION

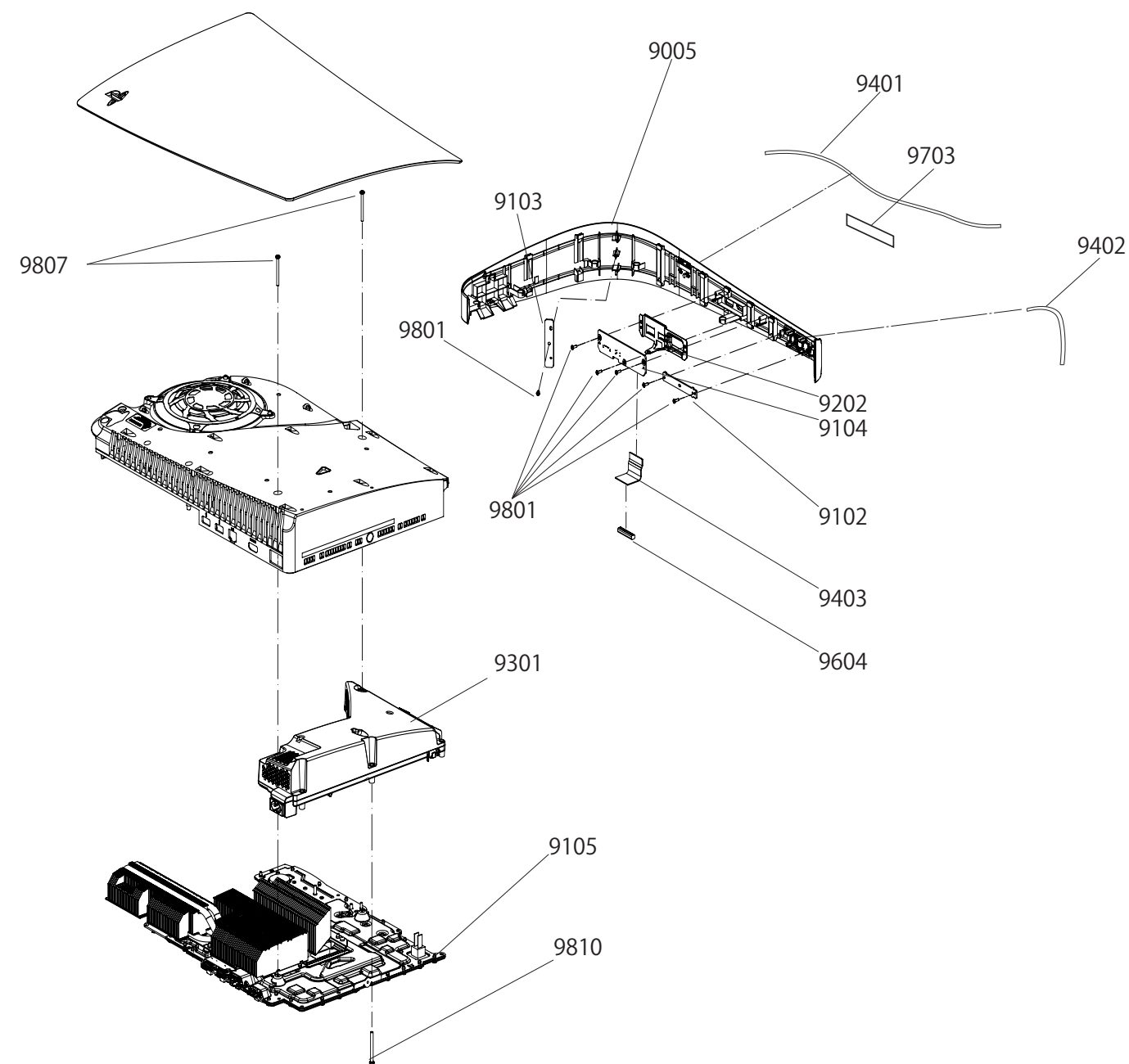

| SC | Ref No. | Description | Specification | Part No. | Remarks |
|----|---------|-----------------------------|---------------------------------------|--------------|------------------------|
| S△ | 9005 | CABINET ASSY , FRONT | with BD-Drive | X-5001-737-2 | |
| | | | without BD-Drive <Digital Edition> | X-5001-736-1 | |
| S | 9102 | EDS-020 COMPL | with BD-Drive | A-5035-292-A | |
| | | | without BD-Drive <Digital Edition> | A-5036-637-A | |
| S△ | 9105 | EDM-020 COMPL(E-F/O)ASSY(S) | with BD-Drive | A-5037-779-A | |
| | | EDM-020 COMPL(E-A/O)ASSY(S) | with BD-Drive | A-5037-780-A | except BR2 , RU3 , E32 |
| | | EDM-020 COMPL(D-F/O)ASSY(S) | without BD-Drive <Digital Edition> | A-5037-781-A | |
| | | EDM-020 COMPL(D-A/O)ASSY(S) | without BD-Drive <Digital Edition> | A-5037-782-A | except BR2 , RU3 , E32 |

| SC | Ref. No. | Part No. | Description | Remarks |
|----|----------|--------------|--------------------------------|------------------|
| S | 9103 | A-5035-295-A | EDL-020 COMPL | |
| S | 9104 | A-5035-298-A | EDU-020 COMPL | |
| S | 9202 | 5-016-780-01 | USB SHIELD | |
| S△ | 9301 | 1-012-308-12 | SWITCHING REGULATOR | |
| U△ | | 1-012-333-11 | SWITCHING REGULATOR | except RU3 , E32 |
| S△ | 9401 | 1-008-451-11 | CABLE, FLEXIBLE FLAT(FFC6EALS) | |
| U△ | | 1-008-452-11 | CABLE, FLEXIBLE FLAT(FFC6EALL) | |
| S△ | 9402 | 1-008-453-11 | CABLE, FLEXIBLE FLAT(FFC6EASS) | |
| U△ | | 1-008-454-11 | CABLE, FLEXIBLE FLAT(FFC6EASL) | |
| S△ | 9403 | 1-008-792-11 | CABLE, FLEXIBLE FLAT(40AUS) | |
| U△ | | 1-008-792-21 | CABLE, FLEXIBLE FLAT(40BUS) | |
| U△ | | 1-008-793-12 | CABLE, FLEXIBLE FLAT(40AUL) | |
| S | 9604 | 5-019-952-11 | GASKET USB FRONT | |
| S | 9703 | 5-019-947-01 | HARNESS FASTENING TAPE | |
| S | 9801 | 4-589-502-12 | SCREW | |
| S | 9807 | 5-019-996-01 | SCREW M2.5X28 | |
| S | 9810 | 5-019-964-01 | SCREW P3X30 | |

| | |
|--|--|
| The components identified by mark △ or dotted line with mark △ are critical for safety. Replace only with part number specified. | Les composants identifiés par une marque △ sont critiques pour la sécurité. Ne les remplacer que par une pièce portant le numéro spécifié. |
|--|--|

1-3. LOWER SIDE SECTION

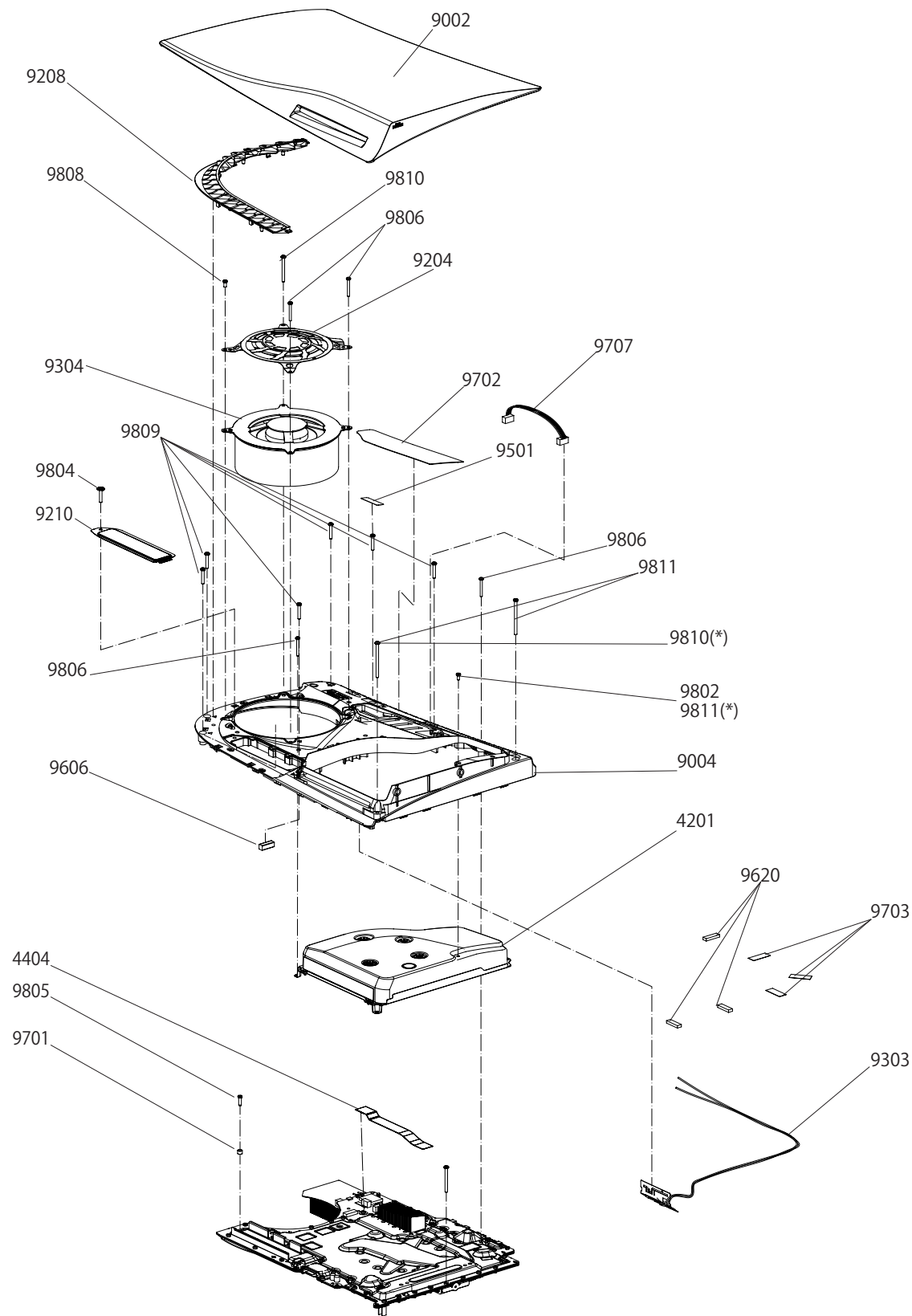

| SC | Ref No. | Description | Specification | Part No. | | | | |
|----|---------|----------------|---------------------------------------|--------------|--------------|--------------|-----|--------------|
| S | 9002 | PANEL LOWER | with BD-Drive | 5-016-788-01 | | | | |
| | | | without BD-Drive <Digital Edition> | 5-016-787-01 | | | | |
| S | 9004 | CABINET LOWER | with BD-Drive | 5-029-375-01 | | | | |
| | | | without BD-Drive <Digital Edition> | 5-029-376-01 | | | | |
| S | 9501 | SEAL , SCREW | | J | AU3 | RU3 | CN9 | BR2 |
| | | | | 5-019-976-02 | 5-019-976-12 | 5-019-976-22 | - | 5-019-976-02 |
| | | | | UCS | EU8 | E32 | | |
| | | | | 5-019-976-02 | 5-019-976-12 | 5-019-976-32 | | |
| S | 9702 | CONNECTOR SEAL | with BD-Drive | 5-019-946-01 | | | | |
| | | | without BD-Drive <Digital Edition> | 5-019-967-01 | | | | |

| SC | Ref. No. | Part No. | Description | Remarks |
|-----|----------|--------------|--------------------------------|------------------------------------|
| - △ | 4201 | A-5035-077-A | DRIVE COMP ASSY (EB)(CO) | with BD-Drive |
| S △ | 4404 | 1-008-396-11 | CABLE, FLEXIBLE FLAT(FFC25EAS) | |
| U △ | | 1-008-397-11 | CABLE, FLEXIBLE FLAT(FFC25EAL) | |
| S | 9204 | 5-016-795-01 | FAN GUARD LOWER | |
| S | 9208 | 5-016-794-01 | INTAKE LOWER | |
| S | 9210 | 5-016-781-01 | M.2 SHIELD | |
| S △ | 9303 | 1-012-243-11 | ANTENNA | |
| U △ | | 1-012-244-11 | ANTENNA | except E32 |
| S △ | 9304 | 1-012-329-11 | DC FAN (G12L12MS1BH-56J14) | |
| U △ | | 1-012-429-11 | DC FAN (KSB1212HGH2M) | except E32 |
| U △ | | 1-012-430-11 | DC FAN (12047GS-12N-WB-01) | except E32 |
| S | 9606 | 5-019-944-01 | GASKET M2 SIDE | |
| S | 9620 | 5-031-167-01 | HARNESS CUSHION | |
| S | 9701 | 5-019-945-01 | SPACER M.2 | |
| S | 9703 | 5-019-947-01 | HARNESS FASTENING TAPE | |
| S | 9707 | 1-008-398-11 | HARNESS, POWER E-N (DRIVE4PAF) | with BD-Drive |
| S | 9802 | 5-019-941-01 | SCREW S2.5X5.7 | |
| S | 9804 | 5-019-957-01 | SCREW M3X16(SHAPES) | |
| S | 9805 | 5-019-958-01 | SCREW M3X10 | |
| S | 9806 | 5-019-959-01 | SCREW S2.5X22 | |
| S | 9808 | 5-019-962-01 | SCREW P3X10 | |
| S | 9809 | 5-019-963-01 | SCREW P3X17 | |
| S | 9810 | 5-019-964-01 | SCREW P3X30 | |
| S | 9810(*) | 5-019-964-01 | SCREW P3X30 | without BD-Drive <Digital Edition> |
| S | 9811 | 5-019-965-01 | SCREW P3X42 | |
| S | 9811(*) | 5-019-965-01 | SCREW P3X42 | without BD-Drive <Digital Edition> |

The components identified by mark △ or dotted line with mark △ are critical for safety. Replace only with part number specified.

Les composants identifiés par une marque △ sont critiques pour la sécurité. Ne les remplacer que par une pièce portant le numéro spécifié.

1-4. MCB BLOCK SECTION

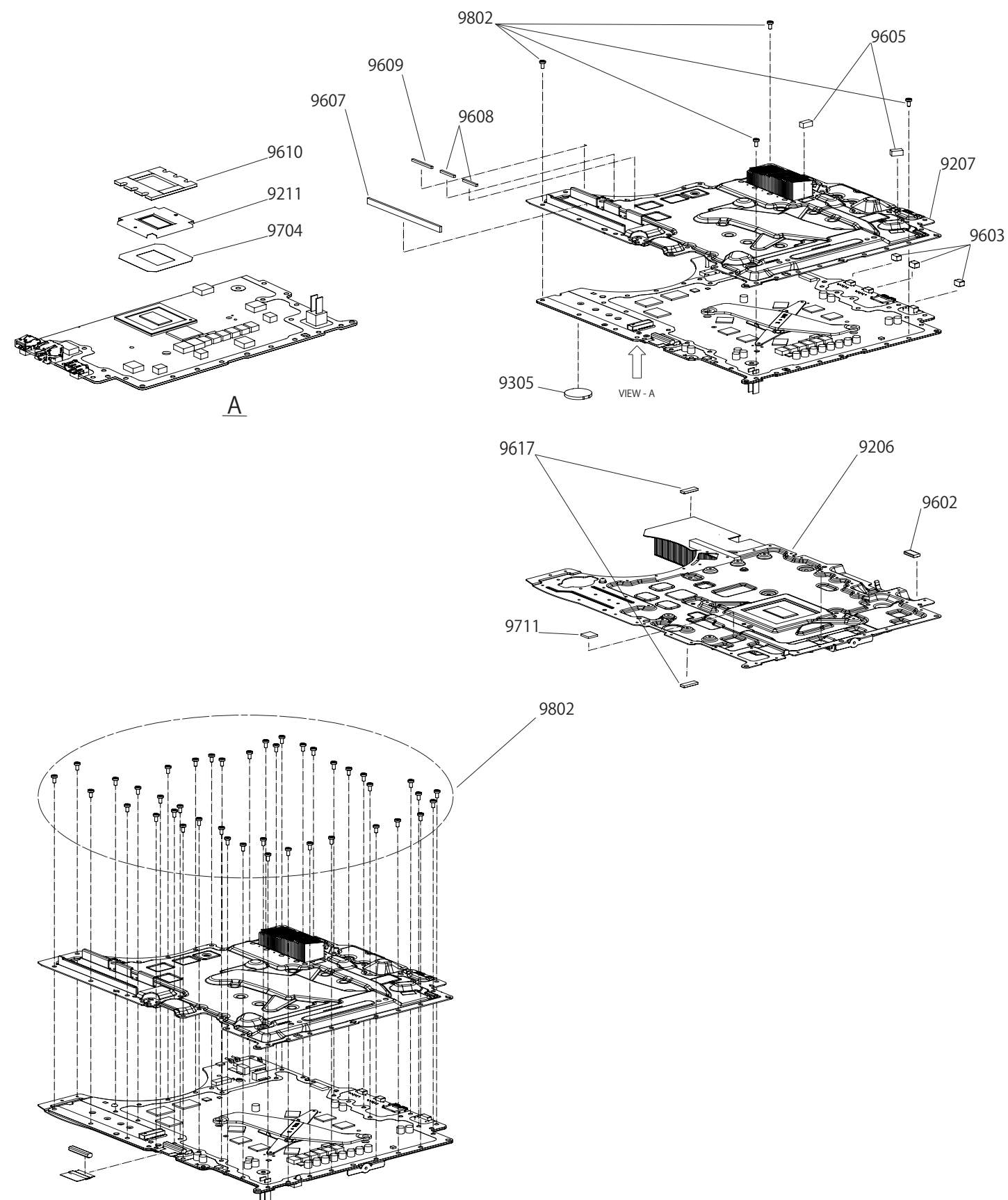

| SC | Ref No. | Description | Specification | Part No. | Remarks |
|----|---------|------------------------|---------------------------------------|--------------|-----------------------|
| U | 9207 | SHIELD ASSY, LOWER (E) | with BD-Drive | X-5002-345-1 | Included in MCB BLOCK |
| | | SHIELD ASSY, LOWER (D) | without BD-Drive <Digital Edition> | X-5002-346-1 | |

| SC | Ref. No | Part No. | Description | Remarks |
|-----|---------|--------------|-----------------------|--------------------------------|
| (U) | 9206 | X-5002-344-1 | SHIELD ASSY, UPPER(B) | |
| S | △ | 9305 | 1-756-873-12 | BATTERY, LITHIUM (CR2032 TYPE) |
| U | △ | | 1-853-172-11 | BATTERY, LITHIUM (CR2032 TYPE) |
| U | △ | | 1-853-172-22 | BATTERY, LITHIUM (CR2032 TYPE) |
| S | | 9602 | 5-019-949-01 | GASKET HDMI UPPER |
| S | | 9603 | 5-019-950-01 | GASKET USB REAR |
| S | | 9605 | 5-019-952-11 | GASKET DRIVE |
| S | | 9607 | 5-019-953-01 | GASKET M2 FRONT |
| S | | 9608 | 5-019-953-01 | GASKET M2 REAR A |
| S | | 9609 | 5-019-953-01 | GASKET M2 REAR B |
| (U) | | 9617 | 5-023-154-01 | CUSHION (5X15X2) |
| S | | 9711 | 5-031-166-01 | SHEET(10X10X1.7),COIL |
| S | | 9610 | 5-019-969-01 | CUSHION SOC |
| S | | 9704 | 5-019-972-01 | SHEET SOC |
| S | | 9211 | A-5032-117-A | CAP ASSY |
| (U) | | | 5-019-971-01 | CAP SOC |
| (U) | | | 7-500-003-45 | SEALING AGENT (SGS3350B) 25G |
| S | | 9802 | 5-019-941-01 | SCREW S2.5X5.7 |
| S | | | 7-500-003-44 | GREASE (CGW-3) 940G/940G |
| S | | | 7-500-003-43 | GREASE (DRG-01B) 500G SIL |

The components identified by mark △ or dotted line with mark △ are critical for safety. Replace only with part number specified.

Les composants identifiés par une marque △ sont critiques pour la sécurité. Ne les remplacer que par une pièce portant le numéro spécifié.

1-5. BD BLOCK SECTION

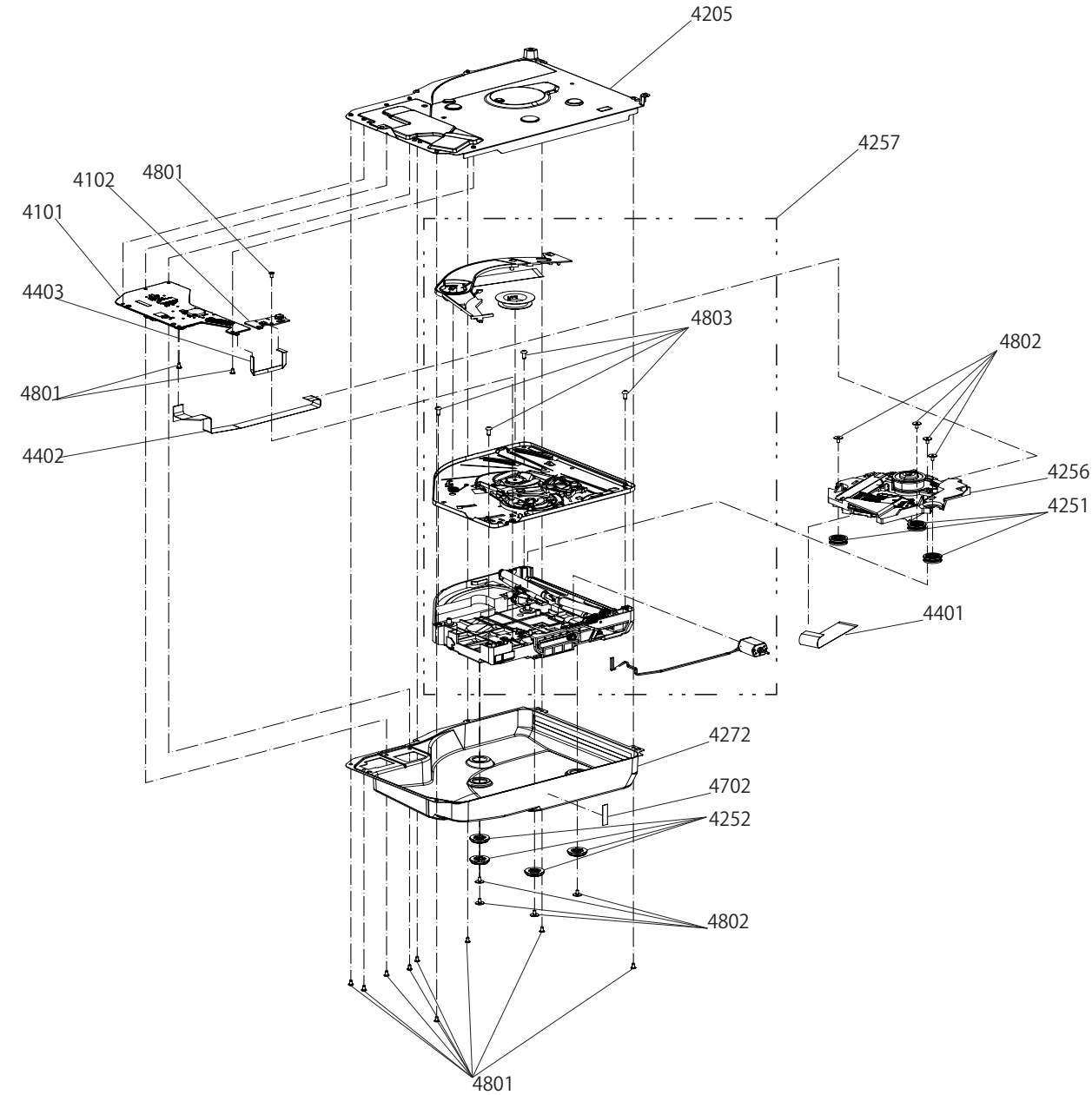

| SC | Ref. No. | Part No. | Description | Remarks |
|-----|----------|--------------|--------------------------------|-----------|
| S | 4101 | A-5035-062-A | UHN-020 COMPL(CO) | |
| S | 4102 | A-5035-078-A | NLU-003 COMPL | |
| U | 4205 | 5-016-056-01 | CASE TOP | |
| U | 4251 | 5-018-642-02 | INSULATOR(BU) | |
| U | | 5-018-642-11 | INSULATOR(BU) | |
| (U) | 4252 | 5-018-643-01 | INSULATOR(BASE) | |
| (U) | | 5-018-643-11 | INSULATOR(BASE) | |
| S △ | 4256 | 8-820-483-01 | DEVICE, OPTICAL KEM-497AAA/C2N | |
| U △ | | 8-820-483-02 | DEVICE,OPTICAL KEM-497AAA/C2N1 | except J1 |
| U △ | | 8-820-483-03 | DEVICE,OPTICAL KEM-497AAA/C2N2 | |
| S | 4257 | A-5035-091-E | FRAME COMPL ASSY (B) (A) | |
| U | | A-5035-092-E | FRAME COMPL ASSY (B) (W) | except J1 |
| (U) | 4272 | 5-016-057-01 | CASE BOTTOM | |
| S △ | 4401 | 1-008-391-11 | CABLE, FLEXIBLEF LAT(FFC40EAS) | |
| U △ | | 1-008-392-11 | CABLE, FLEXIBLE FLAT(FFC40EAL) | |
| U △ | | 1-008-793-12 | CABLE, FLEXIBLE FLAT(FFC40AUL) | |
| S △ | 4402 | 1-008-394-11 | CABLE, FLEXIBLE FLAT(FFC09EAS) | |
| U △ | | 1-008-395-11 | CABLE, FLEXIBLE FLAT(FFC09EAL) | |
| S △ | 4403 | 1-008-393-11 | CABLE, FLEXIBLE FLAT(FFC06EAS) | |
| U △ | | 1-008-400-11 | CABLE, FLEXIBLE FLAT(FFC06EAL) | |
| S | 4702 | 5-018-353-01 | TAPE AL(20X5) | |
| S | 4801 | 4-594-140-21 | SCREW M2X4 | |
| S | 4802 | 5-016-087-01 | SCREW P2 | |
| S | 4803 | 5-016-089-01 | SCREW B2.5 | |

| | |
|--|--|
| The components identified by mark △ or dotted line with mark △ are critical for safety. Replace only with part number specified. | Les composants identifiés par une marque △ sont critiques pour la sécurité. Ne les remplacer que par une pièce portant le numéro spécifié. |
|--|--|

1-6. ACCESSORIES & PACKING MATERIALS

| SC | Ref. No. | Part No. | Description | Remarks |
|----|----------|--------------|-----------------------------|------------------------------------|
| S | 9901 | 1-008-794-32 | USB2.0 CABLE A TO C(J) | Only for UCS |
| S | 9901 | 1-008-795-22 | USB2.0 CABLE A TO C(L) | |
| S | 9902 | 5-020-166-01 | PROTECTION SHEET (1200X700) | |
| S | 9905 | A-5034-351-A | BASE ASSY(E/B) | with BD-Drive |
| S | 9905 | A-5034-350-A | BASE ASSY(E/D) | without BD-Drive <Digital Edition> |
| S | 9906 | 5-030-039-11 | SCREW, KNOB | Screw for BASE ASSY |
| S | 9911 | 1-008-483-12 | HDMI CABLE | Only for UCS |
| S | 9911 | 1-008-483-22 | HDMI CABLE | |
| S | 9915 | 2-897-601-01 | REINFORCEMENT, HANDLE | |
| S | 9917 | 5-020-060-01 | CUSHION L | with BD-Drive |
| S | 9918 | 5-020-061-01 | CUSHION R | |
| S | 9919 | 5-020-969-01 | ACC BOX | |
| S | 9920 | 5-020-970-01 | ACC PARTITION | |
| S | 9921 | 5-030-275-01 | HANDLE(MEASURES) | |

| SC | Ref. No. | Description | Specification | Part No. | | | | | | | | | |
|----|----------|----------------------|---------------------------------------|--------------|--------------|--------------|--------------|--------------|--------------|--------------|--------------|--------------|--------------|
| S△ | 9913 | CONTROLLER, WIRELESS | | J | AU3 | RU3 | CN9 | BR2 | UCS | EU8 | E32 | | |
| | | | | F-2741-896-3 | F-2741-894-7 | F-2741-894-7 | - | F-2741-894-7 | F-2741-894-7 | F-2741-894-7 | F-2741-894-7 | F-2741-896-1 | |
| S△ | 9904 | CORD, POWER | | J | AU3 | RU3 | CN9 | BR2 | UCS | EU8 | E32 | | |
| | | | | 1-009-312-51 | 1-009-366-62 | 1-009-310-62 | - | 1-009-320-62 | 1-009-308-71 | - | 1-009-337-82 | | |
| S | 9907 | INDIVIDUAL CARTON | with BD-Drive | J (EMS) | J (SKZ) | AU3 | RU3 | CN9 | BR2 | UCS (EMS) | UCS (SKZ) | EU8 | E32 |
| | | | | 5-031-556-01 | 5-031-557-01 | 5-031-556-11 | 5-020-736-01 | - | 5-020-736-01 | 5-020-736-01 | 5-021-974-01 | 5-020-736-01 | 5-031-556-31 |
| | | | without BD-Drive <Digital Edition> | J (EMS) | | AU3 | RU3 | CN9 | BR2 | UCS (EMS) | UCS (SKZ) | EU8 | E32 |
| | | | | 5-032-267-01 | - | 5-032-267-11 | 5-020-736-01 | - | 5-020-736-01 | 5-020-736-01 | - | 5-020-736-01 | 5-032-267-31 |
| S | 9908 | MATSER CARTON (2) | with BD-Drive | J (EMS) | J (SKZ) | AU3 | RU3 | CN9 | BR2 | UCS (EMS) | UCS (SKZ) | EU8 | E32 |
| | | | | 5-032-269-01 | 5-031-564-01 | 5-032-270-01 | 5-032-271-01 | - | 5-032-273-01 | 5-031-568-01 | 5-031-566-01 | 5-031-570-01 | 5-032-274-01 |
| | | | without BD-Drive <Digital Edition> | J (EMS) | | AU3 | RU3 | CN9 | BR2 | UCS (EMS) | UCS (SKZ) | EU8 | E32 |
| | | | | 5-032-275-01 | - | 5-032-276-01 | 5-032-277-01 | - | 5-032-279-01 | 5-031-569-01 | - | 5-031-571-01 | 5-032-280-01 |

| | |
|--|--|
| The components identified by mark △ or dotted line with mark △ are critical for safety. Replace only with part number specified. | Les composants identifiés par une marque △ sont critiques pour la sécurité. Ne les remplacer que par une pièce portant le numéro spécifié. |
|--|--|